

M/FLEX for M8.1 and M10

monitor arm system



M/FLEX TRANSFORMS ANY WORKSPACE with unprecedented flexibility and ergonomic performance. Designed for today's agile work environment, users can easily add or remove monitors without disrupting the originally configured installation. This multi-monitor arm system accommodates endless configurations and is fully compatible with Humanscale's next generation monitor arms — providing all of the cutting-edge features of the line.

Easy to install and simple to upgrade for an overall reduced cost of ownership, M/Flex is the most scalable solution available for the modern workplace.



M/Flex's modular design makes it simple to reconfigure and allows for independent adjustment of monitors when they are used separately — encouraging flexibility and collaboration at the workstation.

Its revolutionary adjustable brackets, B1 and B12, allow the user to easily upgrade to multiple monitors without the need to purchase any additional equipment aside from the monitor arm itself. Simply remove the cover and pop the arm into place using Quick Release joints that instantly snap together for a secure fit.

Design Story

Humanscale Design Studio designed M/Flex to be easy to install, simple to upgrade and meet the needs of the ever-evolving workplace. Unlike other multi-monitor solutions, M/Flex has a small footprint and a sleek, minimal aesthetic that will stand the test of time in both performance and design.



Features & Benefits

- Scalable solution accommodates future additions of up to 6 monitors
- Compatible with Humanscale's M8.1 and M10 monitor arms
- Reduces future installation costs by allowing for simple reconfigurations
- Available with accessories such as Notebook Holders, Crossbars, Thin Client Holders, UFEAs, Colored VESA Covers and Sliders
- Patent-pending Smart Stop allows the user to customize the rotation of the arm, preventing overhang and protecting surrounding equipment
- Patent-pending Quick Release Joints instantly snap together for a secure and robust fit, simplifying installation
- Compatible with M/Connect, M/Connect 2 and M/Power, the first-ever integrated monitor arm bases and docking stations of their kind
- Our monitor arms allow the user to place their screen(s) at an optimal ergonomic position
- Flexible rubber channels easily hide, protect, and manage your cables
- A patented, weight-compensating spring technology enables smooth and uniform height adjustment
- A built-in Counterbalance Indicator provides the ability to counterbalance the monitor weight before monitor installation to reduce expensive computer set-up costs





Rubberized Cable Management

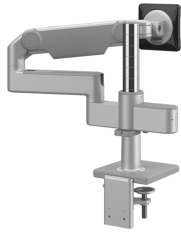

Counterbalance Indicator

Specifications

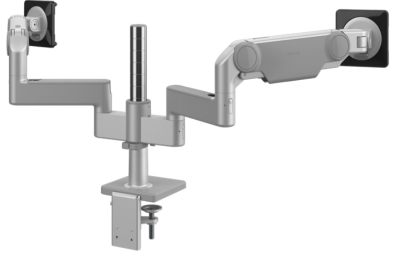
<p>Single 6 - 28 lbs</p>  <p>M/Flex for 8.1 Arms</p>	<p>Dual 6 - 28 lbs per monitor</p> 
<p>Heavy Single up to 20 - 48lbs</p>  <p>M/Flex for M10 Arms</p>	<p>Dual 20 - 48 lbs per monitor</p> 

Maximum Arm Reach	Up to 28"
Maximum Height Adjustment	Up to 10" dynamic
Monitor Capacity	Up to 6 monitors
Color Options	Polished Aluminum with White Trim Silver with Gray Trim Black with Black Trim
Product Material	Recycled Aluminum
Warranty	15 years 24/7

Environmental Story



M/Flex is designed using fewer and lighter components to conserve energy, save valuable resources and reduce its environmental impact. Like all Humanscale products, M/Flex is built with sustainable, non-toxic material and its durable design ensures that it won't need to be replaced for many years.

M/Flex for M8.1 and M10 Specification Guide



Humanscale®

MFlex M8.1 & M10 Posts & Brackets

AVAILABLE COLORS		
	Black with black trim	
	Silver with gray trim	
	Polished aluminum with white trim	
HEIGHT		
12"	13.2 in	334 mm

DIMENSIONS

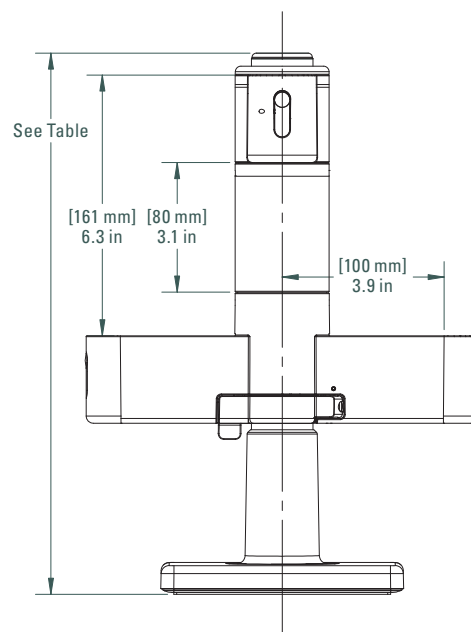
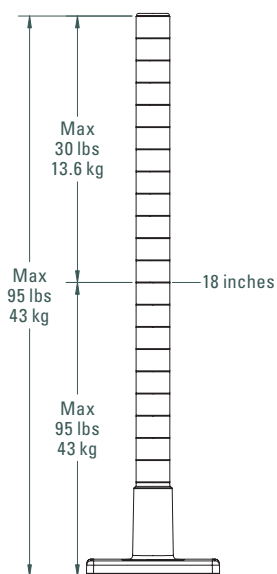
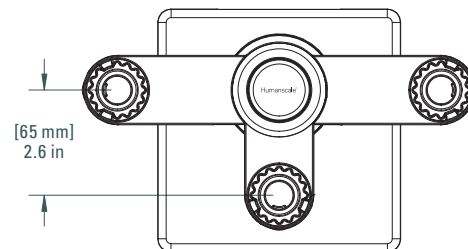

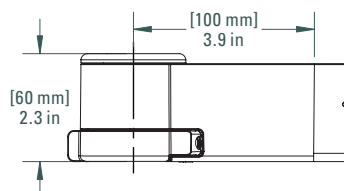

NOTES
<ul style="list-style-type: none"> The maximum weight load should not exceed 95 lbs. Maximum number of monitors supported by a single post is 6. Always use post stops to prevent monitor from swinging behind the clamp.



M8.1 & M10 Static Arm Link

AVAILABLE COLORS

	Black with black trim
	Silver with gray trim
	Polished aluminum with white trim

MAX. WEIGHT CAPACITY

WT	48.0 lbs	21.8 kg
----	----------	---------

SPECIFICATIONS

8 in	2.0 lbs	0.9 kg
------	---------	--------

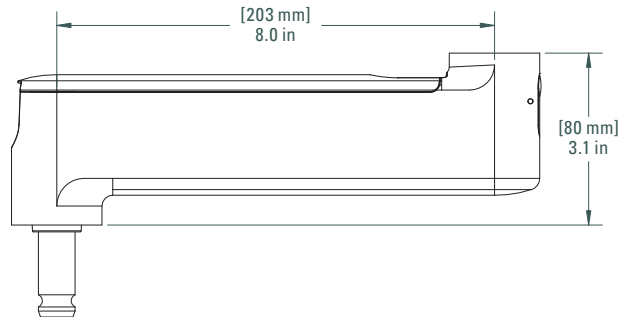

DIMENSIONS



NOTES

- The same static arm links are used for M8.1 and M10.

M8.1 Dynamic Link With Standard Tilt

AVAILABLE COLORS		
	Black with black trim	
	Silver with gray trim	
	Polished aluminum with white trim	
MONITOR WEIGHT RANGE		
WT	6.0 to 28.0 lbs	2.7 to 12.5 kg
WEIGHT		
WT	4.4 lbs	2.0 kg
NOTES		
<ul style="list-style-type: none"> The center of the tilt mechanism can range from 2.4 in (61 mm) below the top of the mount to 7.5 in (191 mm) above the top of the mount. 		

DIMENSIONS

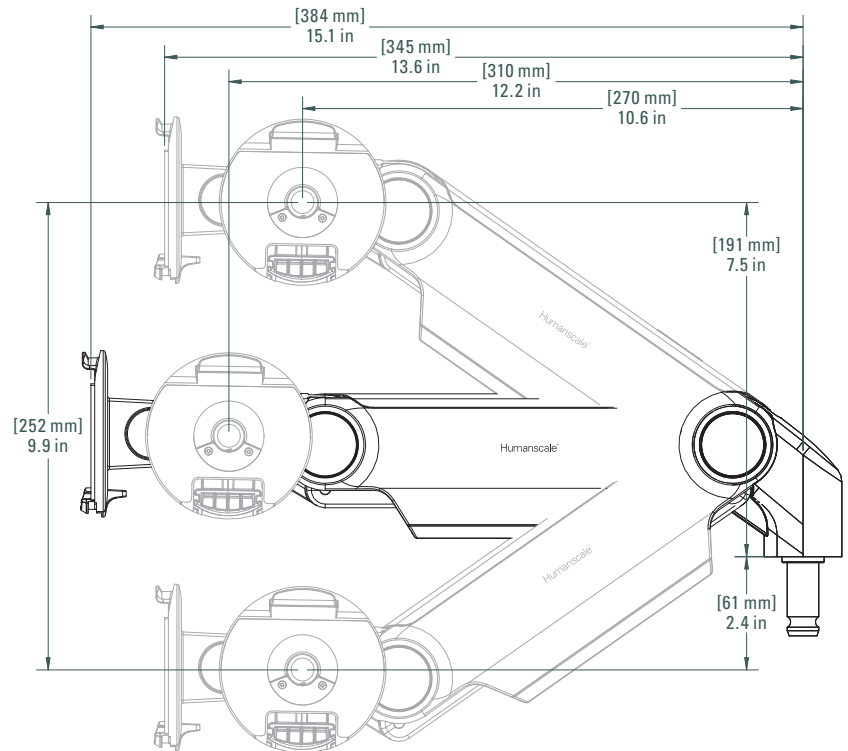

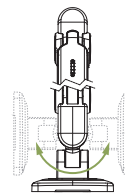
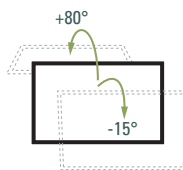

+80° / -15°
Tilt

180°
Left / Right Pan



M10 Dynamic Link With Standard Tilt

AVAILABLE COLORS

	Black with black trim
	Silver with gray trim
	Polished aluminum with white trim

MONITOR WEIGHT RANGE

WT	20.0 to 48.0 lbs	9.0 to 21.8 kg
----	------------------	----------------

WEIGHT

WT	4.6 lbs	2.1 kg
----	---------	--------

NOTES

- The center of the tilt mechanism can range from 2.0 in (52 mm) below the top of the mount to 7.8 in (199 mm) above the top of the mount.

DIMENSIONS

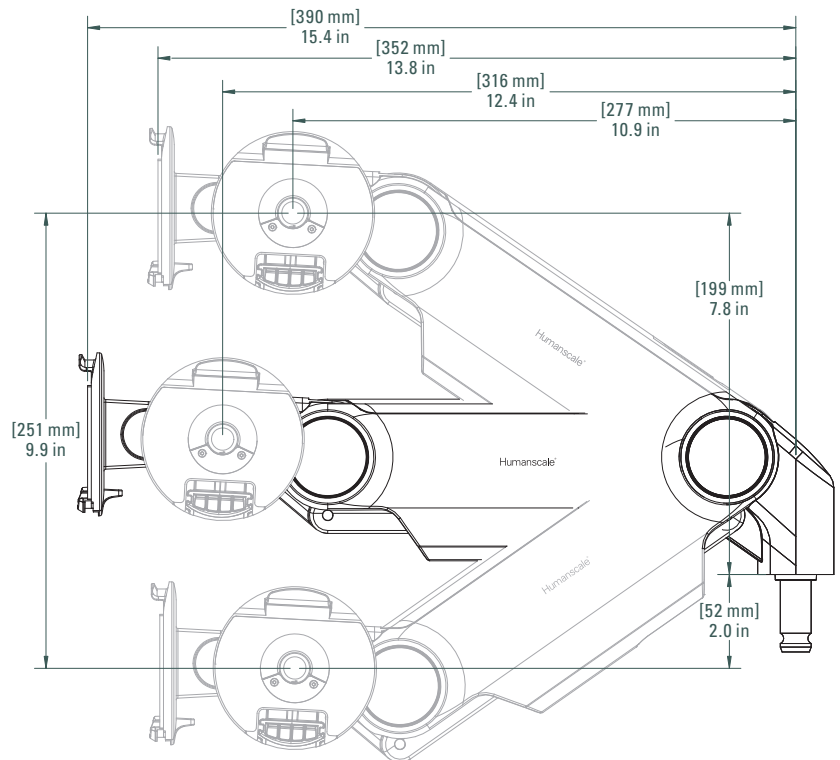

+80° / -15°
Tilt

180°
Left / Right Pan

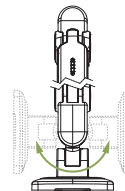
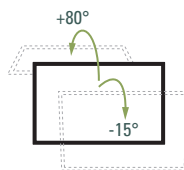

MFlex 8.1 Screen Size Accommodations: Double Link Style

		MONITOR WIDTH		DIMENSION A		DIMENSION B	
Arm Style	Description	TWO MONITORS		in	mm	in	mm
E	8"/Dynamic	45	1104	11.9	304	22.5	552

NOTES

- Dimensions provided are for actual monitor width.
- Slider adds 4.6 inches (118 mm) of adjustment to each side with maximum weight capacity of 12.5 lbs (5.7 kg).
- Do not exceed weight limitations.

DIMENSIONS

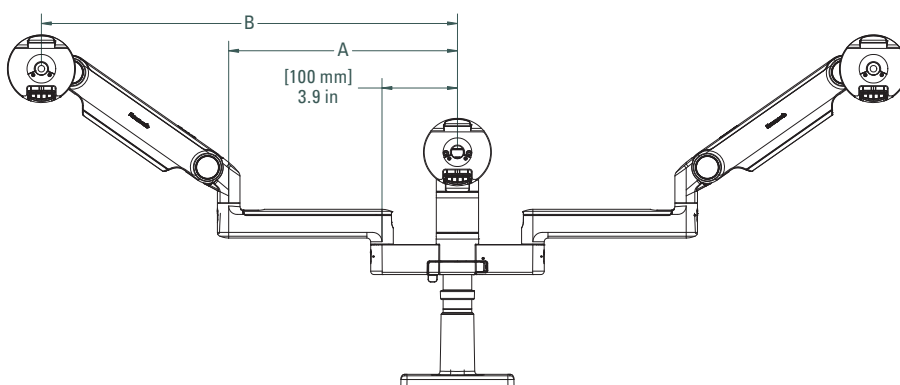

MFlex 10 Screen Size Accommodations: Double Link Style

		MONITOR WIDTH		DIMENSION A		DIMENSION B	
Arm Style	Description	TWO MONITORS		in	mm	in	mm
		E	8"/Dynamic	45.6	1104	11.9	304

NOTES

- Dimensions provided are for actual monitor width.
- Do not exceed weight limitations.

DIMENSIONS

